

DETALLE 1 - ESC.1/10

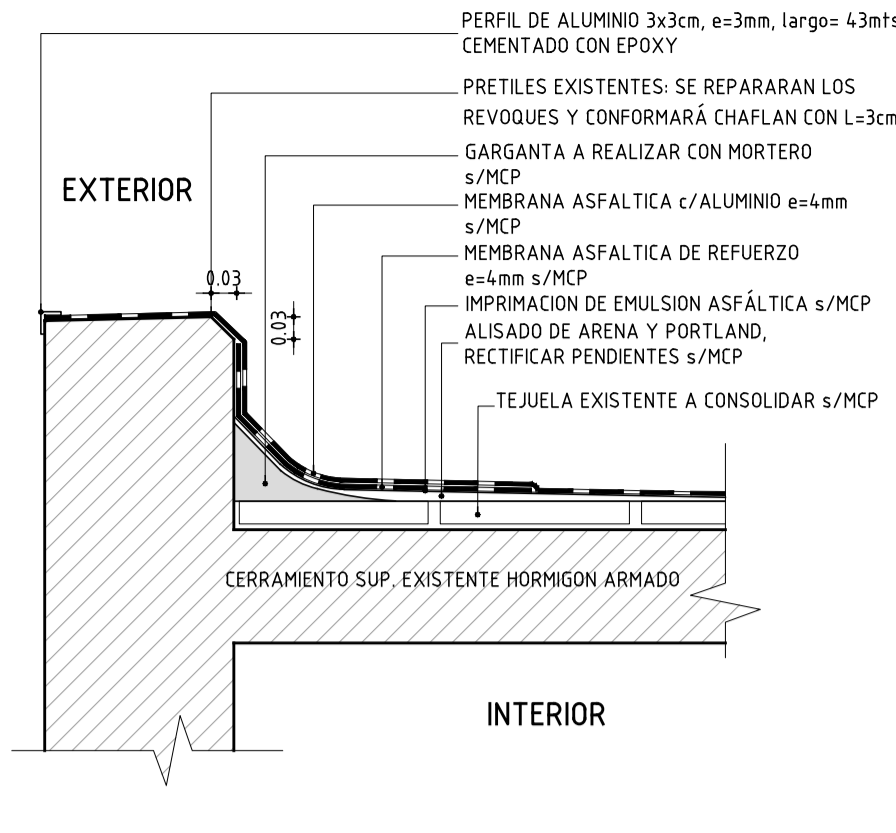

DETALLE 2 - ESC.1/10

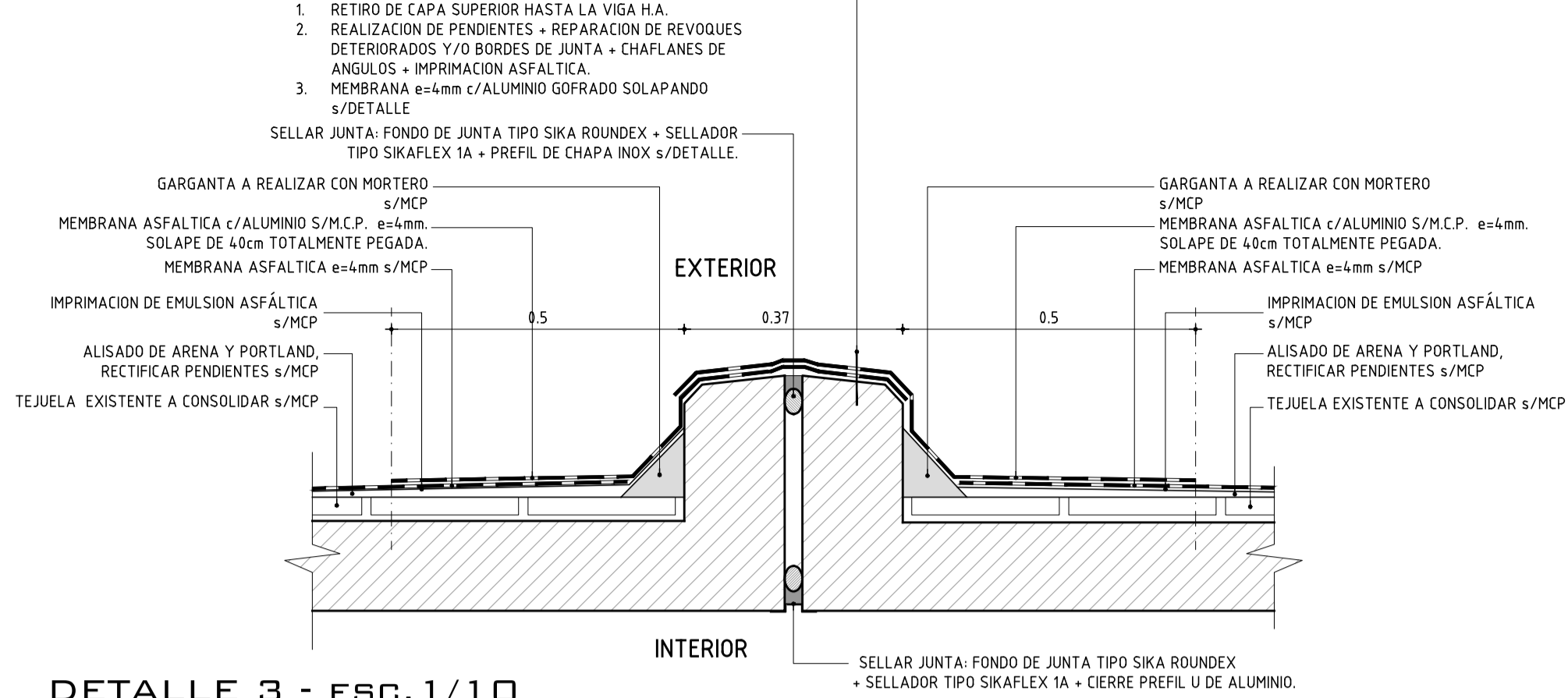

DETALLE 3 - ESC.1/10

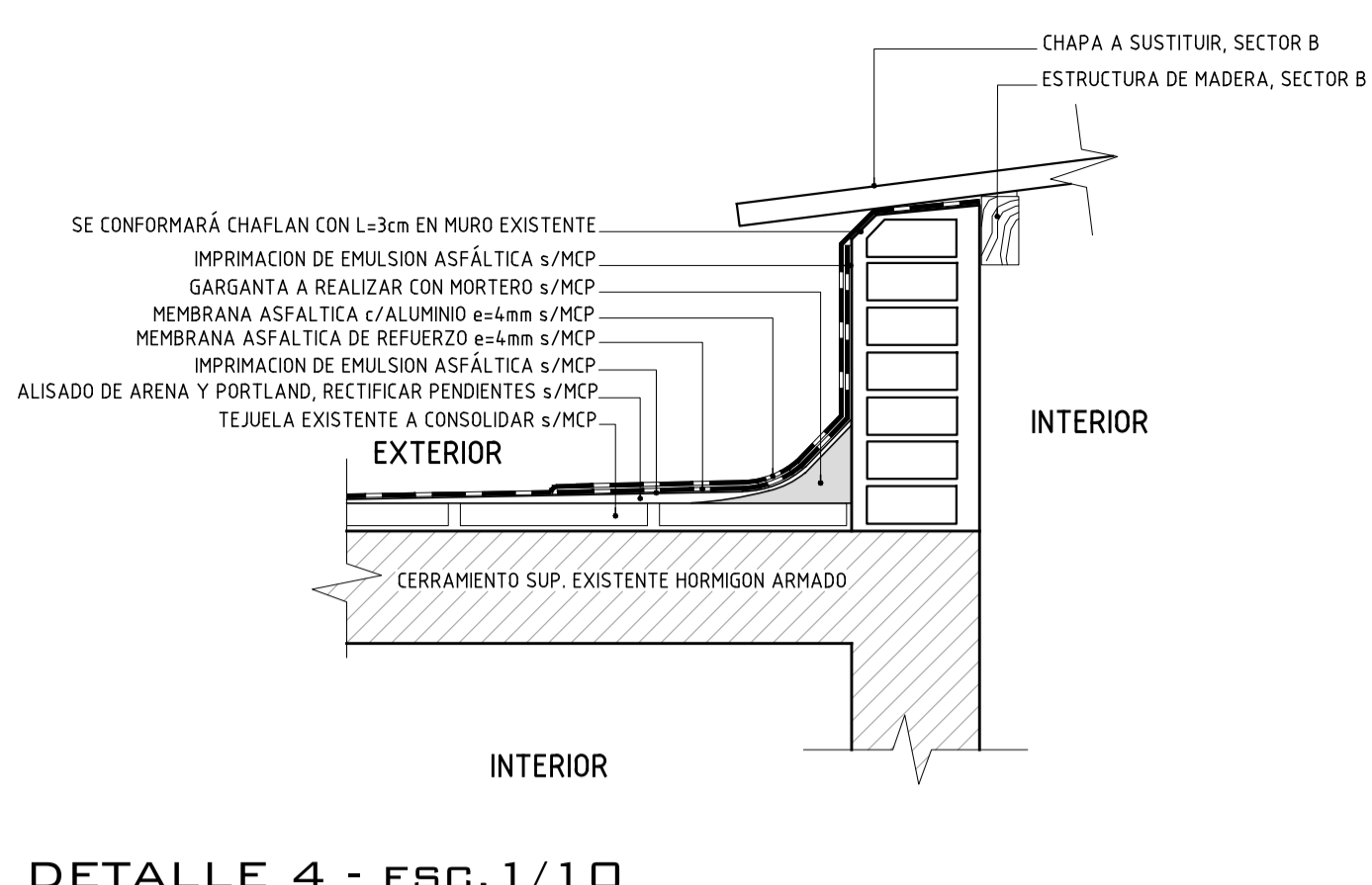

DETALLE 4 - ESC.1/10

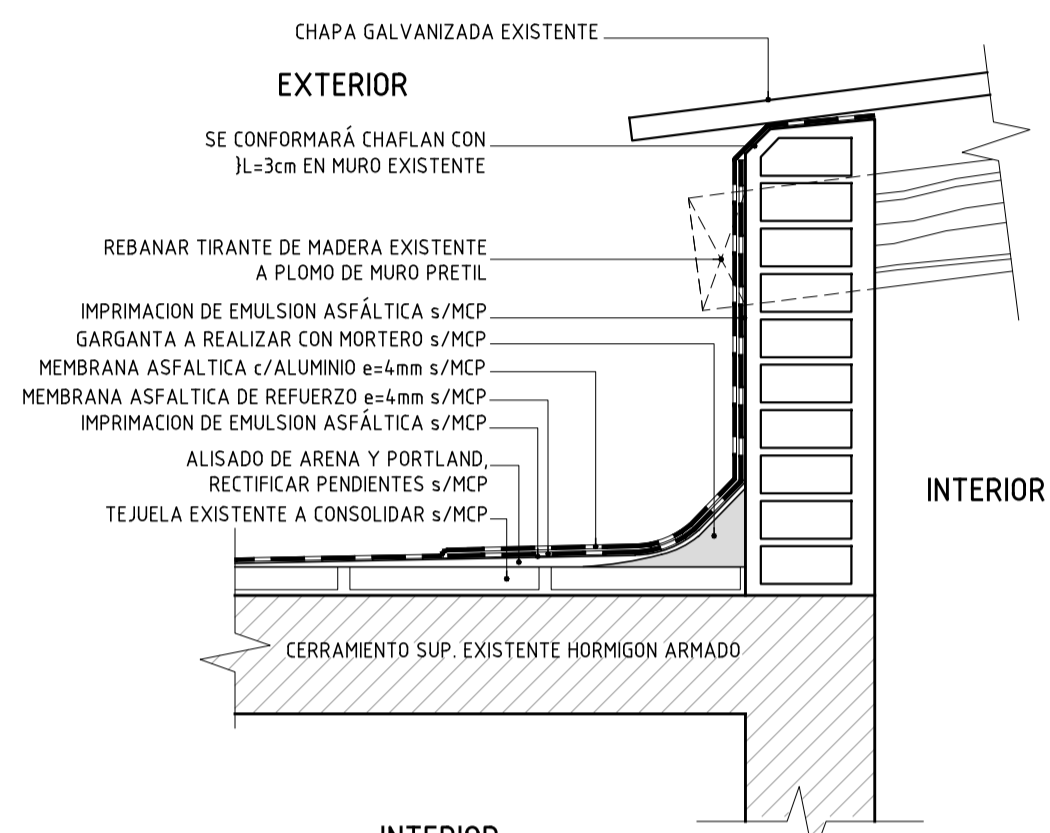

DETALLE 5 - ESC.1/10

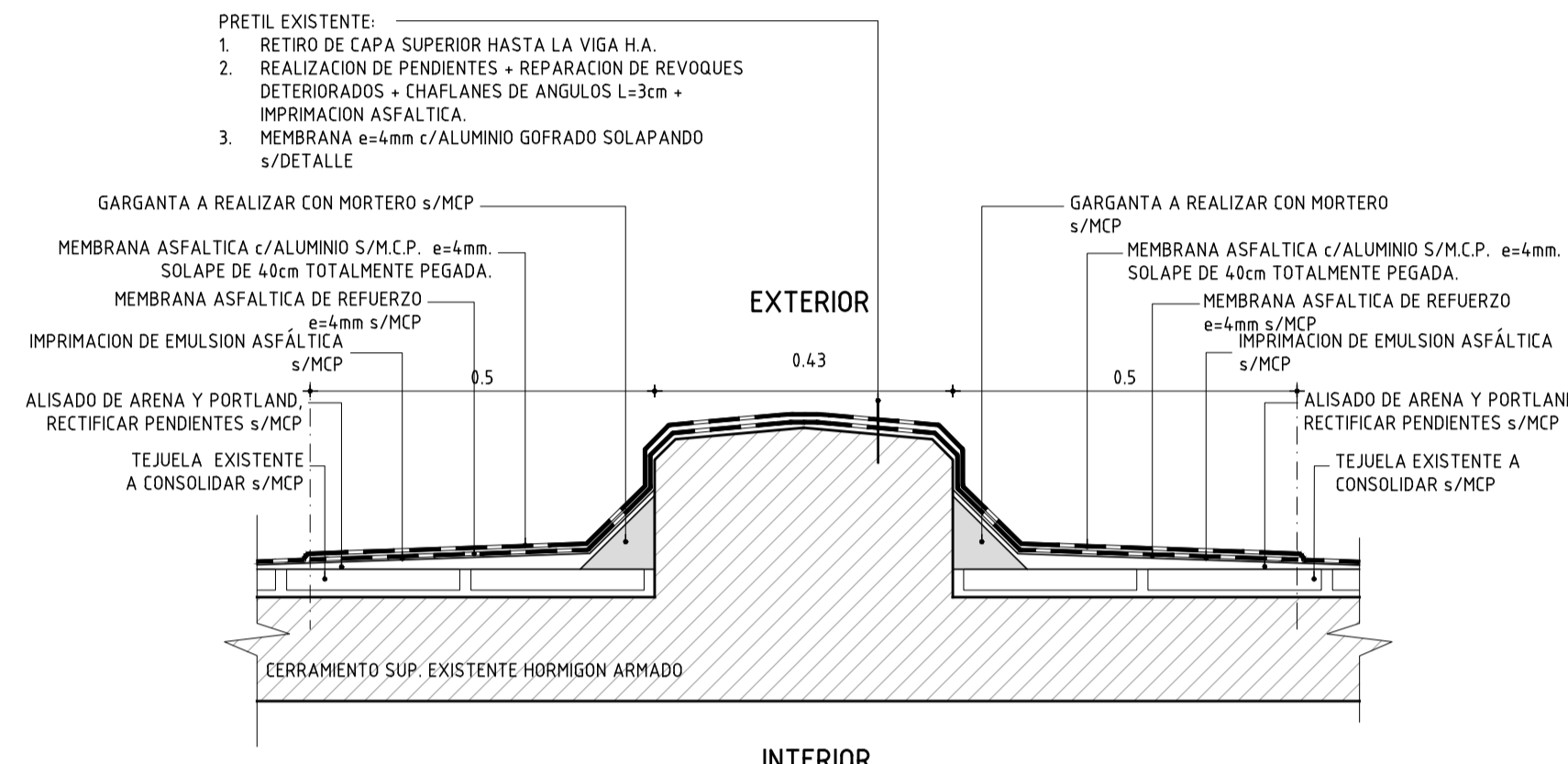

DETALLE 6A - ESC.1/10

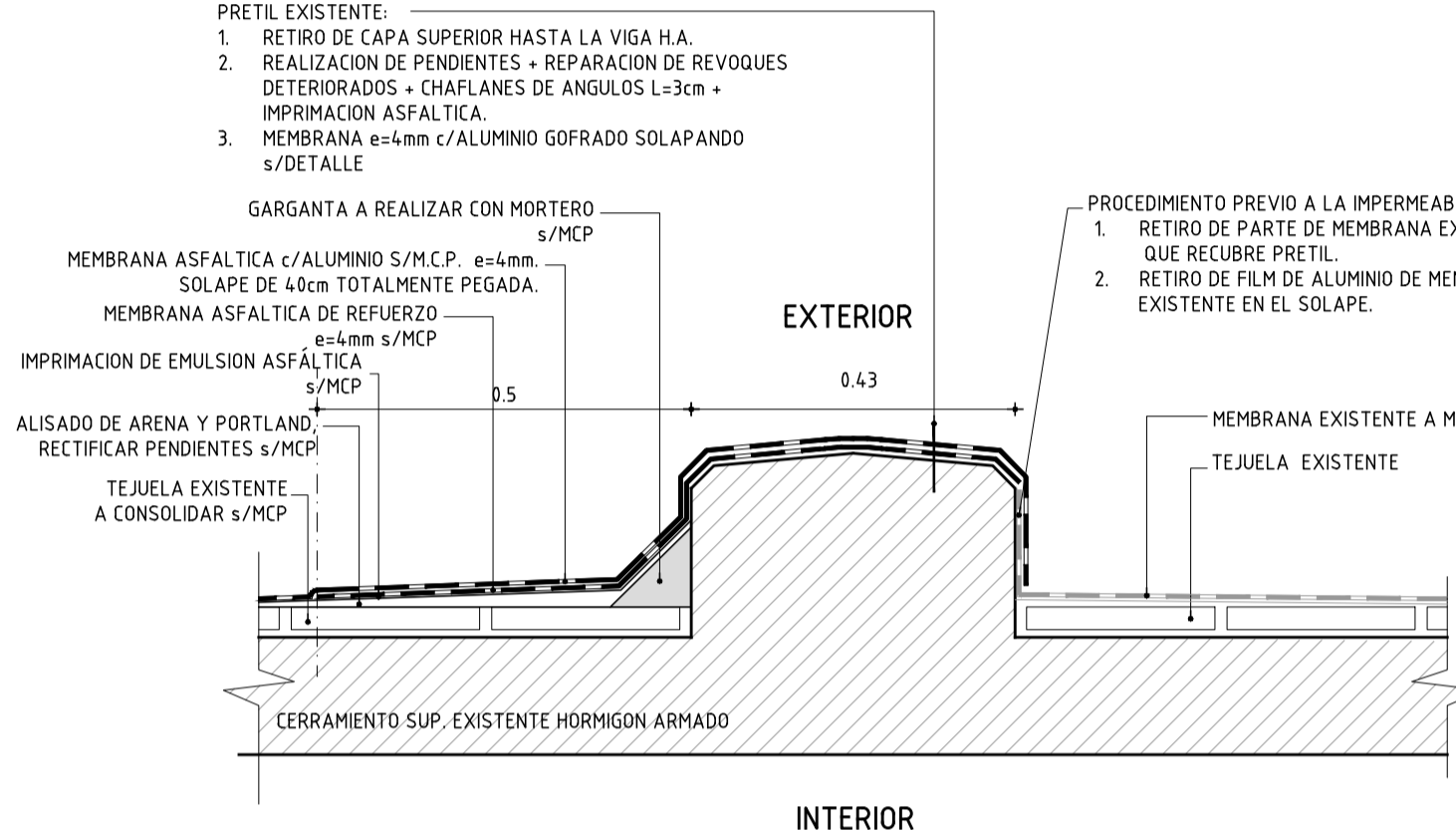

DETALLE 6B - ESC.1/10

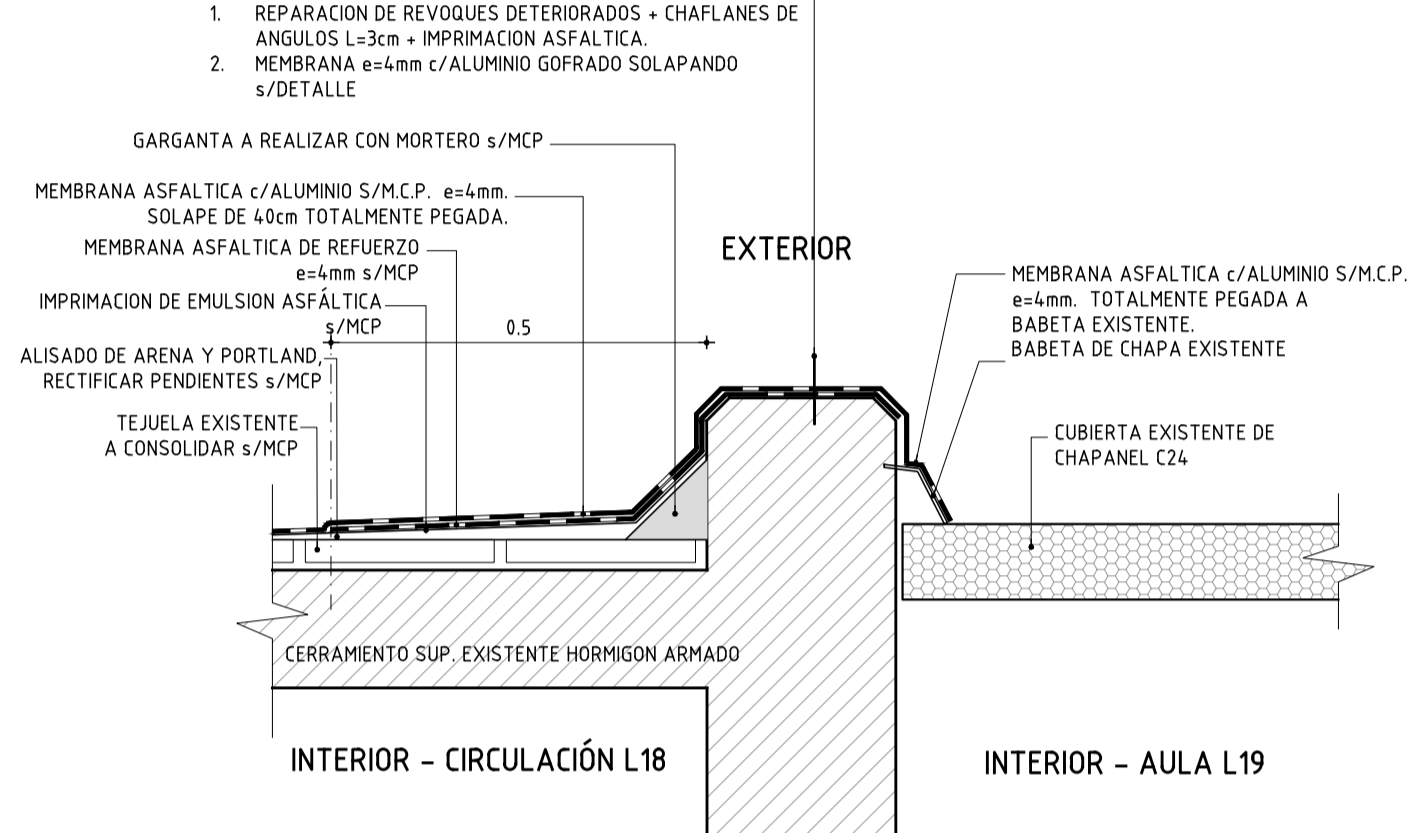

DETALLE 6C - ESC.1/10

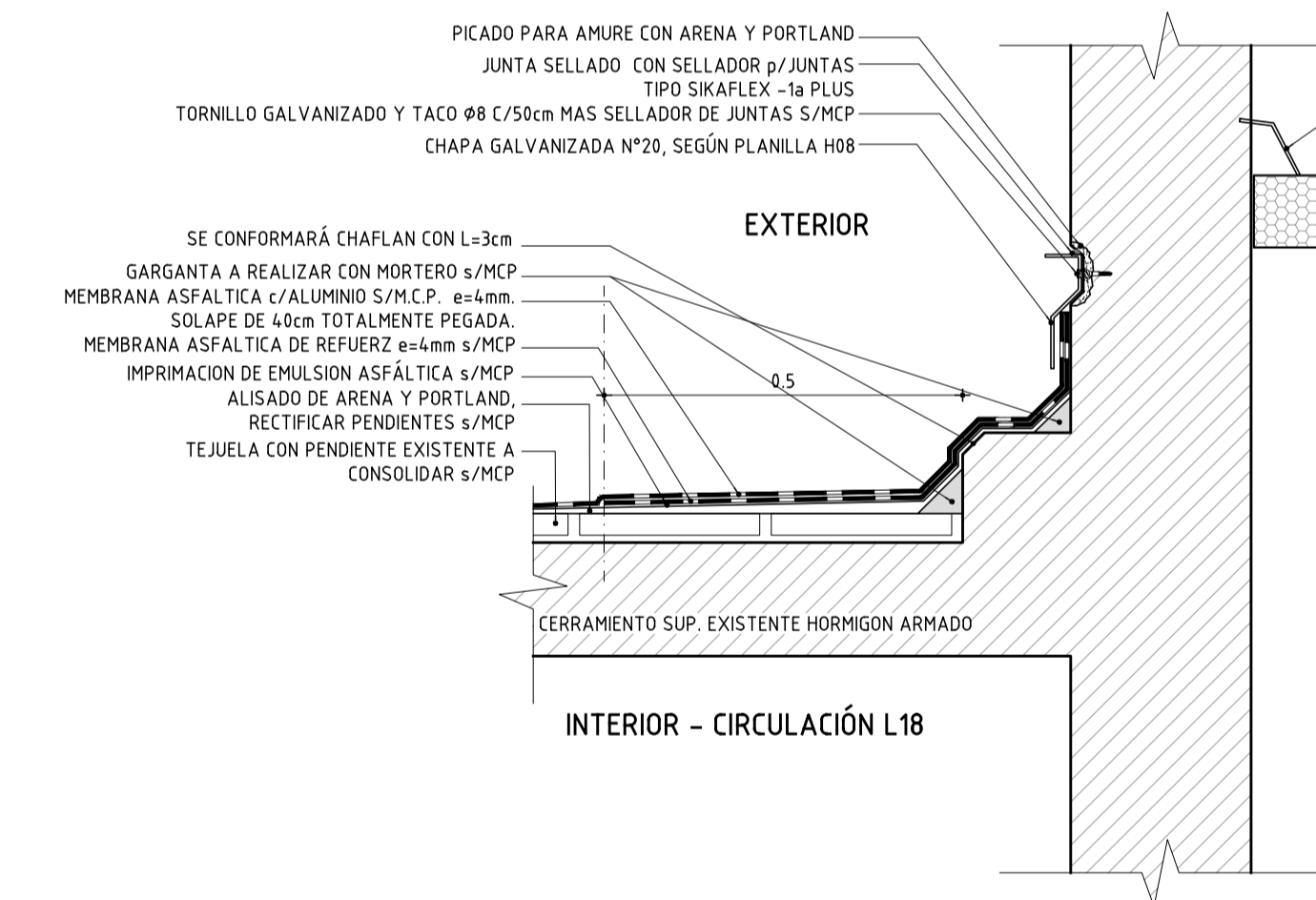

DETALLE 7 - ESC.1/10

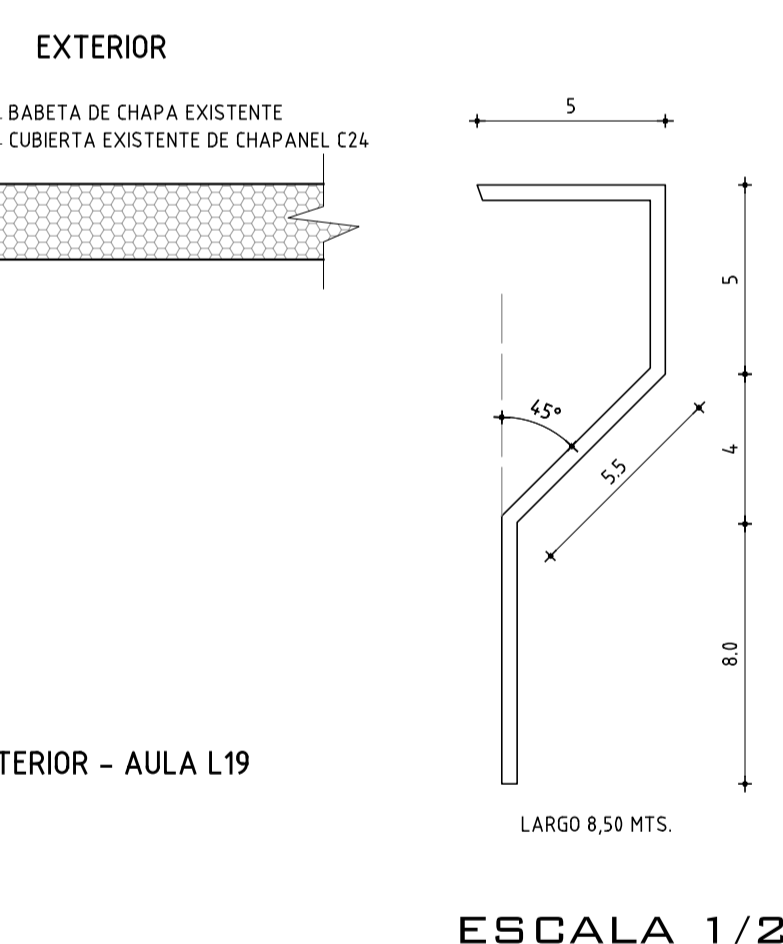

ESCALA 1/2

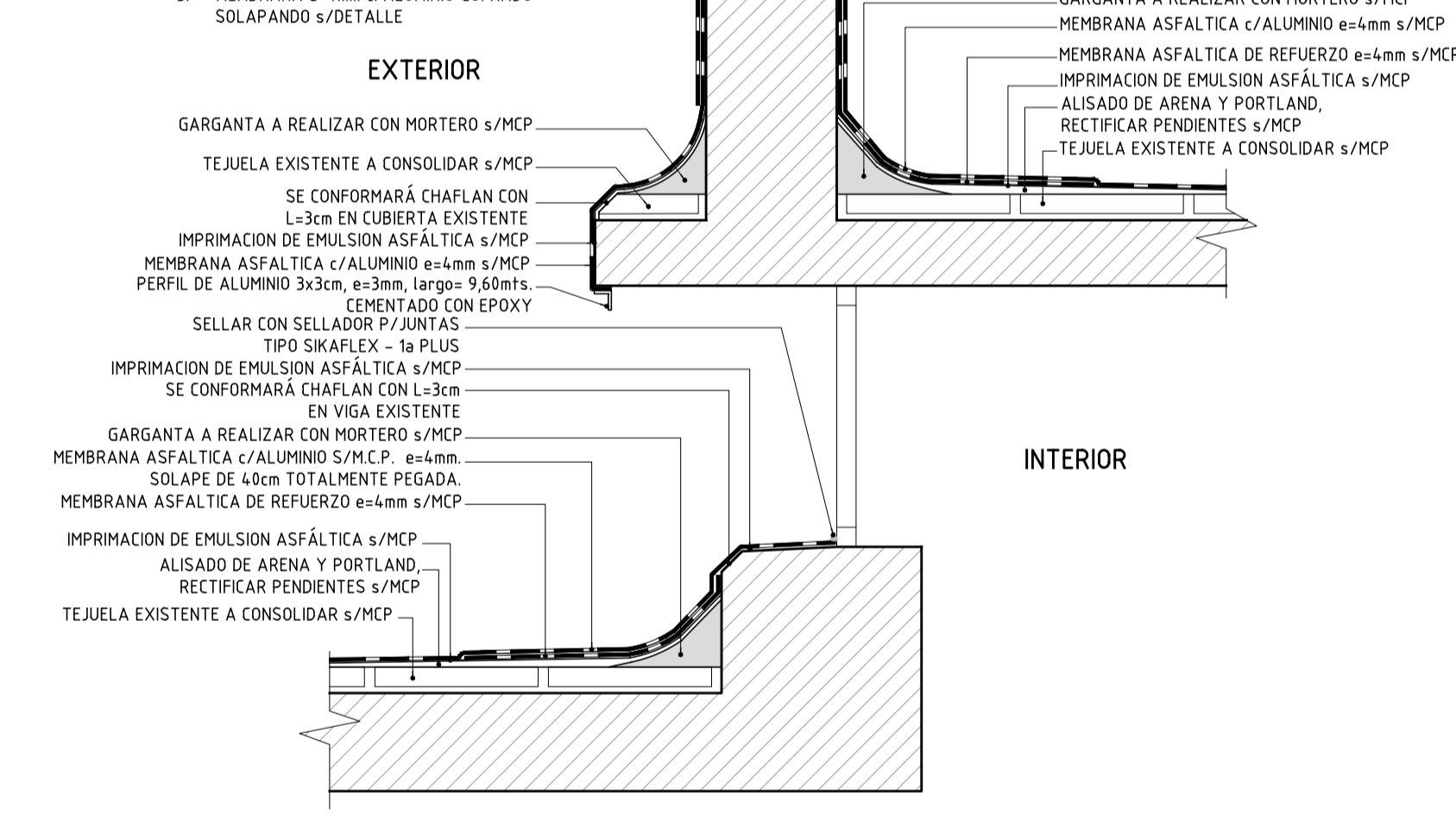

DETALLE 8 - ESC.1/10

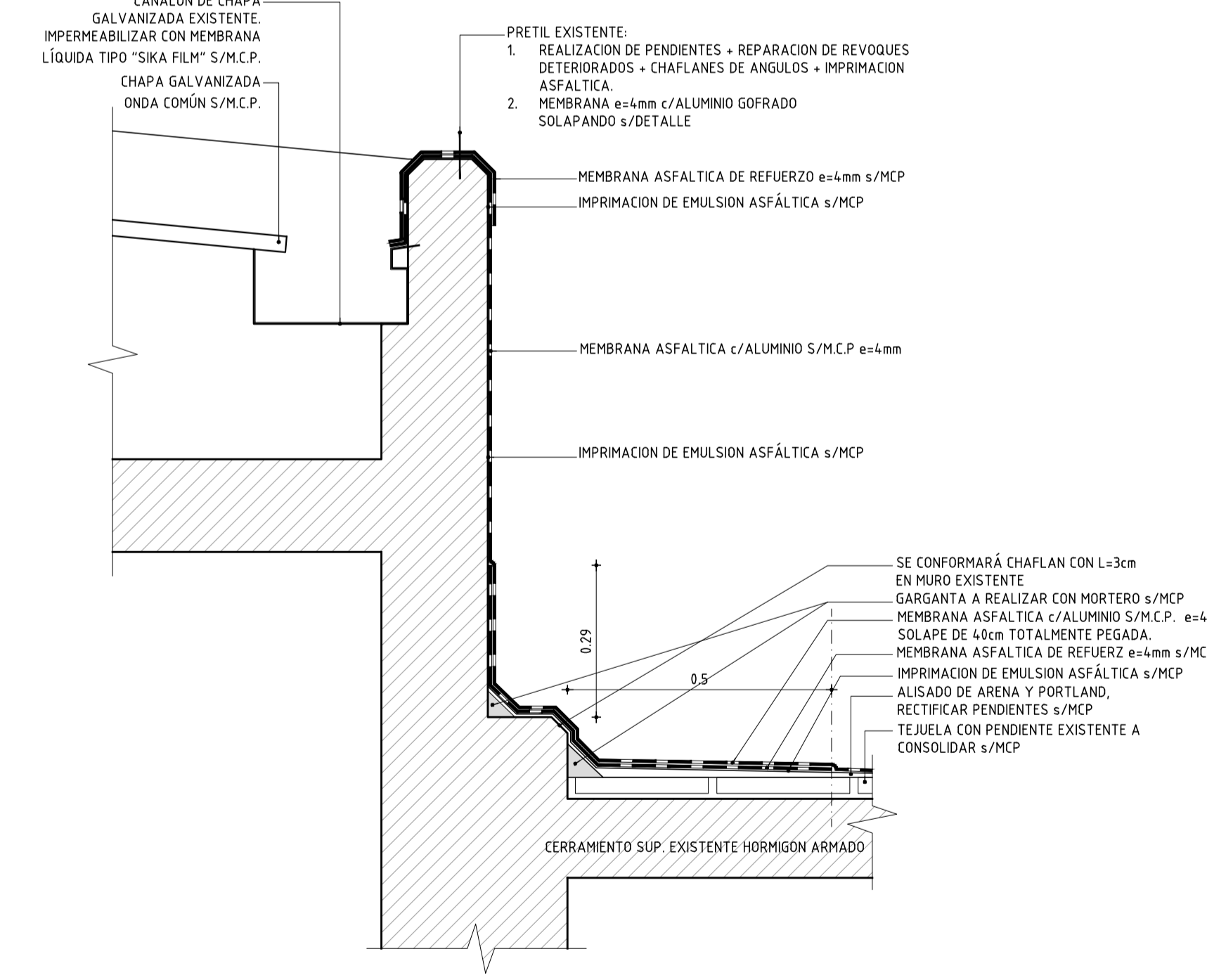

DETALLE 10 - ESC.1/10

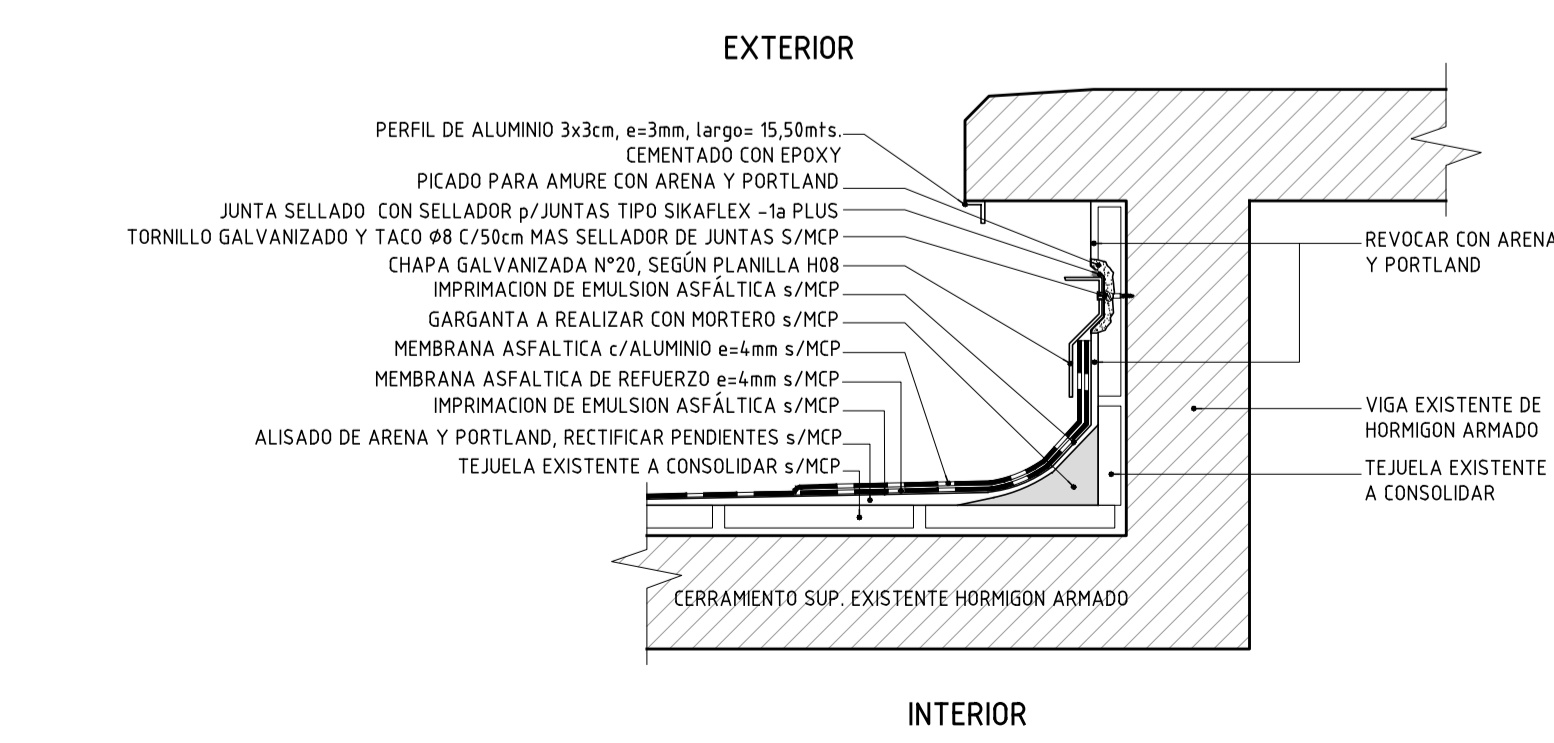

DETALLE 9A - ESC.1/10

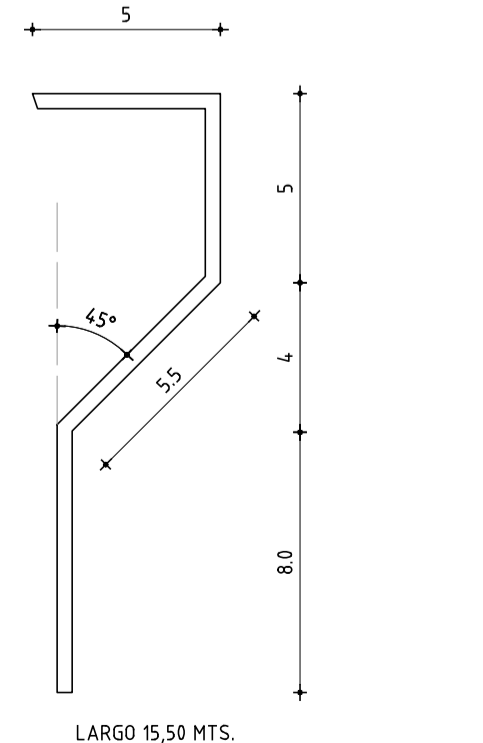

ESCALA 1/2

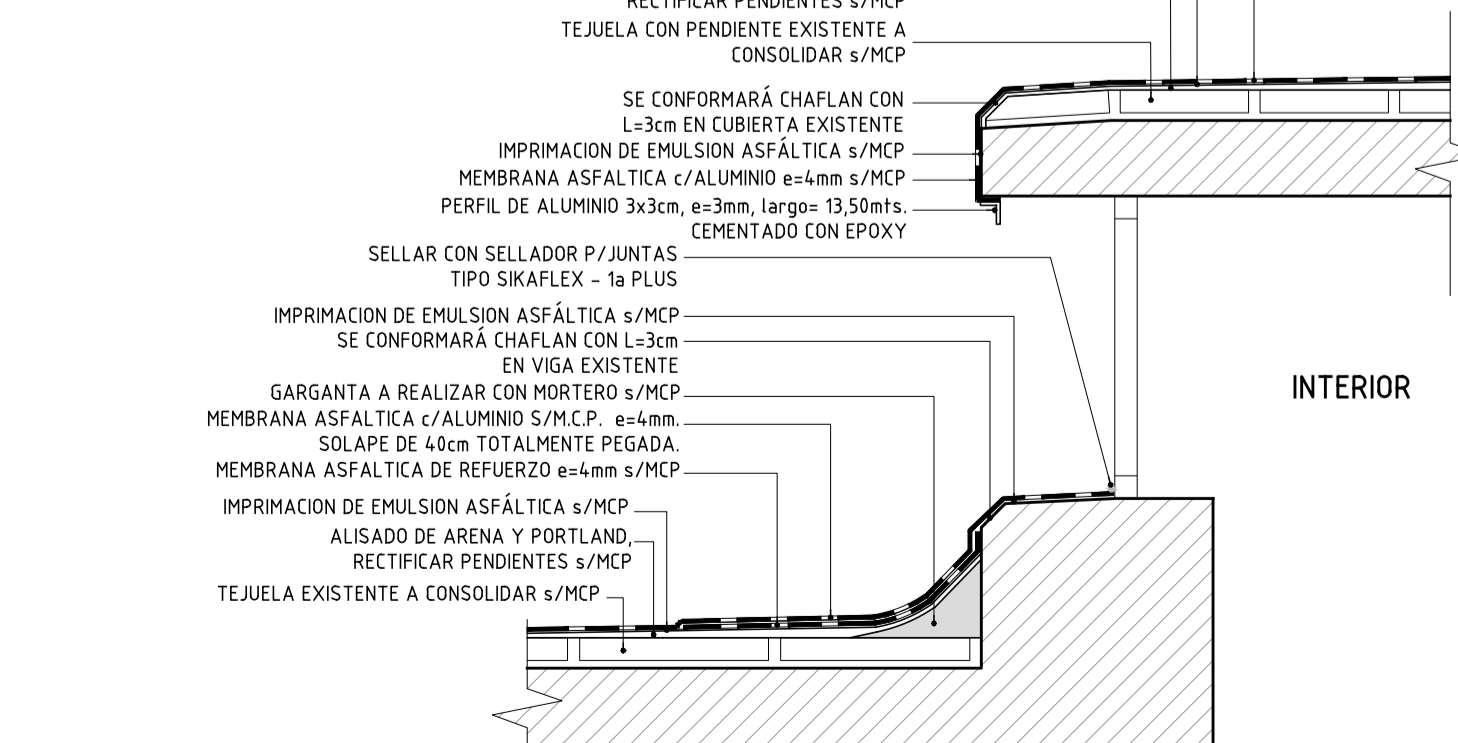

DETALLE 11 - ESC.1/10

ANEP AREA DE PROYECTOS			
DIRECCIÓN SECTORIAL DE INFRAESTRUCTURA			
CONSEJO DIRECTIVO CENTRAL			
OBRA: ESCUELA Nº42/100	LOCALIDAD: PAYSANDÚ	FECHA: JULIO 2022	L 12
Calle Joaquín Suárez Esq. Charrúas	DEPARTAMENTO: PAYSANDÚ	ESCALA: 1/10 - 1/2	
PLANO DE: ALBANILERÍA	DETALLES - SECTOR C1		L 12
ARQUITECTO: ERNESTO MARTÍNEZ PUONZO	FIRMA:		
AYTE. DE ARTO: ROSSANA GONZÁLEZ	FIRMA:		
TECNICO:	FIRMA:		
A07			